



SUBMITTAL DATA SHEET

Job Name :		Location:
Contractor:		Engineer:
Submitted by:	Reference:	Approval:
Phone:	Date:	
Unit designation:	Model number :	Qty:
Unit designation:	Model number :	Qty:

CEILING TUBULAR VENTILATION FAN

MODELS: BPT15A-80, BPT15A-110



FEATURES

GRILL

Polymeric construction
 Contemporary design
 Soft white for better agancing

FAN HOUSING

PC/ABS polymeric
 Polymeric duct connector with tapered sleeve without metallic clatter for quiet operation
 Easy four-point mounting directly to joist
 7.8" height allow for 2"x8" joist installation
 2 hanger bars to positioning anywhere between 16" to 24" on center joist

MOTOR

Heavy duty, plug-in, life time lubrication, 4 pole
 Permanently split capacitor
 Rated 120/1/60

Suitable for use over tub or shower enclosure when installed in a GFI protected branch circuit. This product must be installed by a qualified technician

1 YEAR WARRANTY

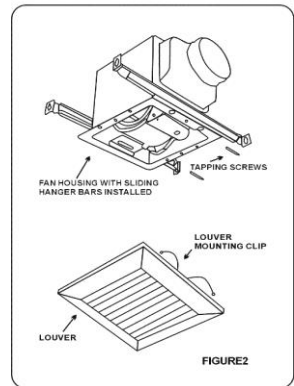
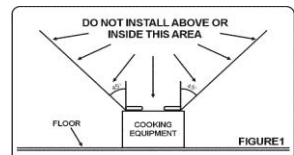

SPECIFICATIONS

Model	Wheel (mm)	Housing Size (mm/Inch)	Duct size (mm)	Speed	Power (W)	Air Flow (CFM)				Energy Efficiency Rate @0.1	Noise (SONE)
						@0.0	@0.1	@0.25	@0.4		
BPT15A-80	150mm	9"x9"x7.8" 230x230x198mm	Φ100	/	25	83,4	80,7	76,2	62,4	3,34	0,83
BPT15A-110					30	114,9	112,6	105,4	81,9	3,83	1,42